

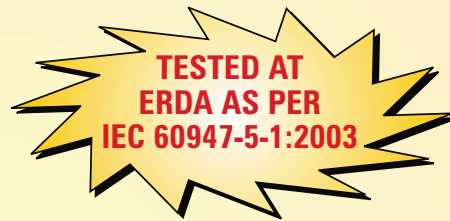

# KAYCEE

Brand that set the standards

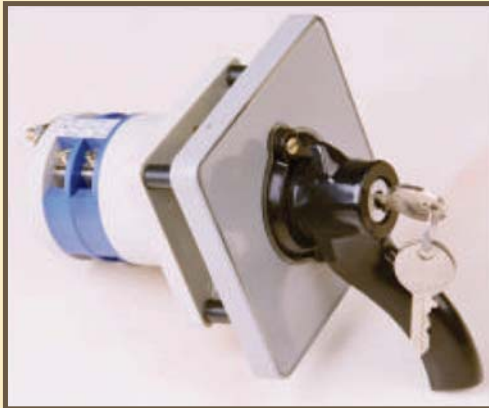
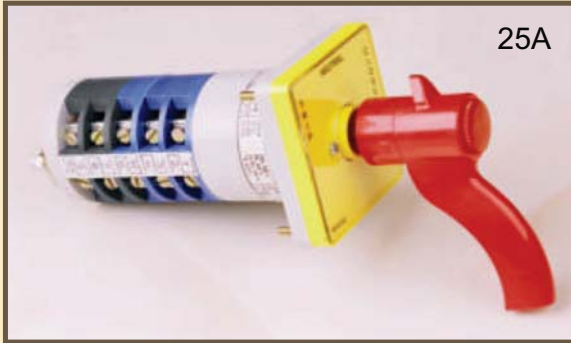

## ■ KAYCEE BREAKER CONTROL SWITCHES : (25A & 32A)

### ■ SPECIFICATION:

Utilization Category AC-15, AC-23, AC-21,  
DC-22 & DC-13 As Per IEC 60947-5-1:2003  
I.S.13947 Part I & V / Sec. 1:2004

### ■ FEATURES :

- Compact Design
- Double Break butt Contact
- Stay Put
- Spring Return
- Lost Motion
- Sequence Locking
- Locking Facility.
- 45°, 60°, 90° angle of throw.
- Common Mounting Plate Suitable for Standard + ODS Mounting

*Kaycee for Commitment...*  
*Kaycee for Quality...*



KAYCEE BREAKER CONTROL SWITCHES

## ELECTRICAL DATA :

Continous Current (Ith)	- 25A / 32A
Operational Voltage	- 660 Volt
High Voltage Test	- 2.5 KV (R.M.S.)
Ambient Temperature	- 55°
Frequency of Operation	- 300 cycles / Hour
Mechanical Life	- 1 Million Cycles of Operation
Electrical Life	- 1 Lac Operations
Short Time Withstand Current	- 250 A for 1 Sec.(25 Amp) - 300 A for 1 Sec.(32 Amp)
Short Time Making & Breaking Capacity	- 250 A (25 Amp) - 300 A (32 Amp)

### DC BREAKING CAPACITY (25 Amp)

Voltage	Resistive	Inductive 10 m Sec.	Inductive 20 m Sec.	Inductive 40 m Sec.
50	20	20	15	6
110	3	2.5	1.5	1
220	1.5	0.5	0.3	0.2

### DC BREAKING CAPACITY (32 Amp)

Voltage	Resistive	Inductive 10 m Sec.	Inductive 20 m Sec.	Inductive 40 m Sec.
50	25	20	7.5	6.5
110	4	4	3	1.5
220	4	2.5	2	0.5

ITEM	DESCRIPTION	WIDTH	MECHANISM				
			'A'	'B'	'C'	'D'	'E'
1	Earthing Plate	15.0	15.0	15.0	15.0	15.0	15.0
2	Base Plate	06.5	06.5	6.5	06.5	06.5	-
3	Pack (L.M.D.)	12.7	-	-	-	-	-
4	Pack	12.7	-	-	-	-	-
5	Spring Return Mech.	20.0	20.0	20.0	20.0	20.0	20.0
6	Seq. Locking Device	12.0	-	-	12.0	12.0	-
7	Housing Cover No. 3	06.5	06.5	06.5	06.5	06.5	-
8	Flush Plate	07.0	07.0	07.0	07.0	07.0	07.0
9	Stay Put Mechanism	16.0	-	-	-	-	16.0
	Total 'X'	-	45.00	55.00	66.00	66.00	38.00

- MECHANISM 'A' - Spring Return
- MECHANISM 'B' - Spring Return + Lost Motion Device
- MECHANISM 'C' - Spring Return + Seq. Locking  
Lost Motion Device
- MECHANISM 'D' - Spring Return + Seq. Locking
- MECHANISM 'E' - Stay Put Mechanism

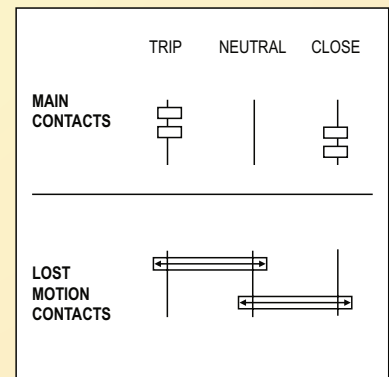
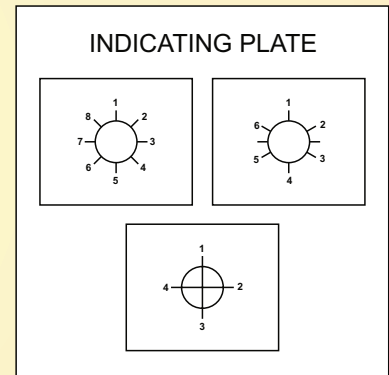
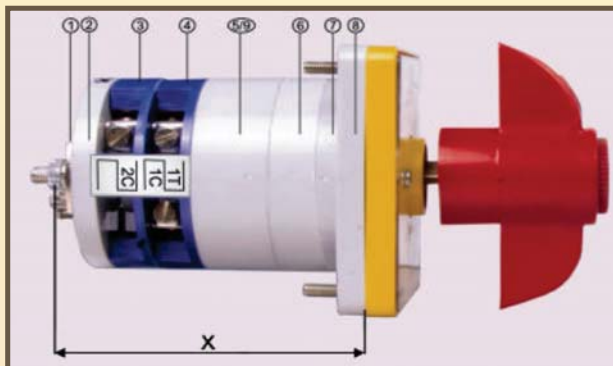

## CODING SYSTEM :

The Breaker Control Switches will bear the code number; its details are given below:

1	2	3	4	5	6	7	8	9
B	C							

### (3) Mechanism:

- A. Spring Return,
- B. Spring Return with Lost Motion Device
- C. Spring Return with Lost Motion Device plus Sequence Locking.
- D. Spring Return with Sequence Lacking.
- E. Stay Put.

### (4) & (5) : No. of Standard packets (2 electrical ways per packet).

Example;

01 = 1 Packet = 2 Electrical ways.      02 = 2 Packets = 4 Electrical ways.

### (6) Type of Handles

\*L = Lever Type Handle

P=Pistol Grip Handle

\*T = TEE Type Handle

W=Wing Type Handle

\* Available with Barrel Lock

### (7) & (8) : No. of packets with Lost Motion Device.

Example:

01 = 1 Packet = 2 Electrical ways.      02 = 2 Packets = 4 Electrical ways,

### (9) Angle of throw:

4 = 45°

6 = 60°

9 = 90°

## PANEL CUTOUT DETAILS

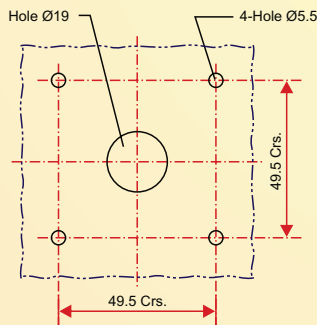

**CS-C10231**  
Breaker Control Switch With  
O.D.C. Mounting (Non-Lokable)

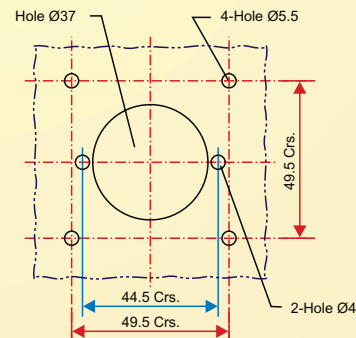

**CS-C10188**  
Breaker Control Switch With Barrel Locking  
(Lever Type or 'T' Type)

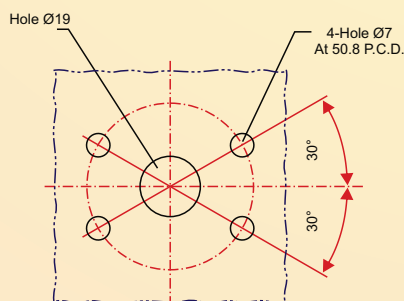

**CS-C10232**  
Breaker Control Switch With  
O.D.C. Mounting (Non-Lokable)

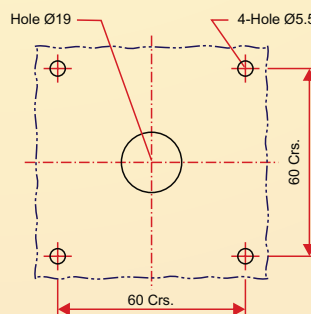

**CS-C10105**  
Breaker Control Switch  
With Standard Mounting

# KAYCEE OTHER PRODUCTS

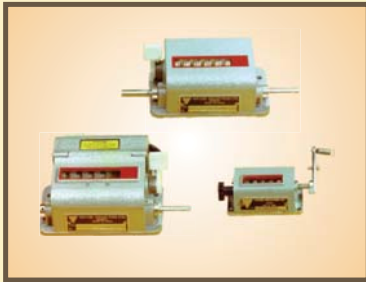

Manufactured by :  
**KAYCEE INDUSTRIES LIMITED**

32, Ramjibhai Kamani Road, Ballard Estate,  
 Mumbai - 400 001.  
 Tel. : +91 (22) 2261 3521 / 22 / 23  
 Fax : +91 (22) 2261 6106  
 E-mail : [kayceeindltd@vsnl.com](mailto:kayceeindltd@vsnl.com)  
 Website : [www.kayceeindustries.com](http://www.kayceeindustries.com)

**Branch Offices :**  
 Delhi : 093120 04687  
 Kolkata : 093392 00968  
 Indore : 093007 51464  
 Bangalore : 093428 53324  
 Chennai : 093812 01556



01-01-2010